

Exhibition Calendar

Monday, February 4, 2008

Deadline for entries

Monday, March 31, 2008

Artists' notification will be mailed

October 22 - November 23, 2008

Exhibition Dates

Target Gallery Floorplan

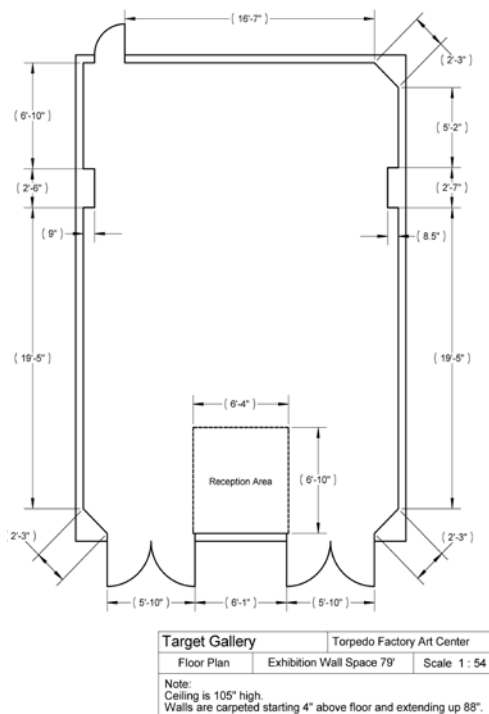

Please see "Limitations" for size requirements.

Guidelines

All work must be for sale. A commission of 40% will be taken on all works sold as a result of this exhibition. Payment will be mailed to the artist within 30 days of the exhibition closing. Works are insured while in Target Gallery. Artists are required to sign a Loan Agreement and a Terms & Condition Agreement if accepted. The Target Gallery will keep the slides and images of accepted works and reserves the right to reproduce the images for all media and publicity purposes.

Delivery

Artists are responsible for shipping their work to the gallery in sturdy, reusable boxes. **Please do not use shipping popcorn.** Return shipping must be prepaid and enclosed with artwork. Neither Target Gallery nor the Torpedo Factory Art Center will be responsible for any damage incurred in transit. Accepted artwork may also be hand-delivered on **Friday, October 10, 2008, between noon and 5 PM.**

Limitations

Work should be less than 15 feet overall (height + width + length), with no one dimension measuring more than 8 feet. Final measurements must be inclusive of frame, if applicable. Weight may not exceed 150 pounds. All entries must have been conceived and created by the artist submitting the work. All work selected must be ready for exhibit: 2D work must be framed with secure hanging devices; 3D work must be suitably prepared with instructions for installation. The gallery reserves the right to reject work that differs from submitted images.

Application

The application materials must be received in the Target Gallery no later than **5 pm on Monday, February 4, 2008.**



prospectus

2008 Open Exhibition CALL FOR PROPOSALS

October 22 - November 23, 2008

This is an Open Call for proposals for an exhibition in the Fall of 2008. This call is open to all artists from North America working in all visual media. Proposals for exhibitions by both individuals and groups will be considered.

The individual or group associated with the chosen proposal will receive a solo exhibition at the Target Gallery from October 22 - November 23, 2008.

**DEADLINE:
February 4, 2008**

www.torpedofactory.org



105 N. Union St.
Alexandria, VA 22314
703 - 838 - 4565 x 4

targetgallery@torpedofactory.org

Jury Process

A three part panel consisting of artists and art professionals not affiliated with the Torpedo Factory Art Center will review all applications. One non-voting representative from the Target Gallery will also be present during the final group review. The final exhibition may reflect the selection of one applicant or a combination of applicants.

Jurors

Courtney Ruch - Independent Contemporary Art Curator

Kurt Godwin - Professor of Painting, Virginia Commonwealth University

Margaret Boozer - Professional Ceramic Artist

About the Gallery

The Target Gallery, the national exhibition space of the Torpedo Factory Art Center, is run by the Torpedo Factory Artists' Association. Artists on the Target Gallery Committee are responsible for the planning of exhibitions and overall mission of the gallery. The Target Gallery promotes high standards of art by continuously exploring new ideas through visual media in a schedule of national and international exhibitions. The gallery hosts nine exhibits annually--some juried, some curated--featuring a variety of themes and artists. In an effort to keep our perspective challenged, our exhibits are usually composed of artists outside of the Torpedo Factory and represent artistic views from across the nation.

Directions For Entry

1. Image entry will be PC compatible JPEG digital files and by 35mm slides only. **Review will be by digital image only.** We strongly suggest digital submission. All 35mm slides will be scanned before jury and require an additional \$3 fee per slide. We regret that we cannot review images via email. Only one detail image per each work may be included. CDs must contain the artist's name on both the actual CD and the case. JPEGs should be no larger than 300 dpi at approximately 4 by 6 inches. All digital files must be in JPEG format and must include the artist's name and title of the submission (smithpainting5.jpg). Please do not use quotations or spaces in file names. Slides must be labeled with the artist's name, title, media, and dimensions. Mark the lower left-hand corner of the front with a red dot.

Video and time-based submissions should be both PC and Macintosh compatible. Submissions must be able to play in standard media viewing programs such as DVD, QuickTime, or Windows Media players (**.MOV files are preferred**). You may NOT submit VHS tapes. **Website links will not be accepted as submissions.**

2. Include a self-addressed stamped envelope (SASE) with sufficient postage for the return of slides or CDs.
3. A non-refundable fee of \$35.00 must accompany each entry form. **All 35mm slide submissions will require an additional charge of \$3.00 per slide.** Checks are to be made payable to the Torpedo Factory Artists' Association.
4. The entry form must be complete and include media, price, and dimension information.

2008 Open Exhibition CALL FOR PROPOSALS

Entries must be received no later than:

Monday, February 4, 2008

ENTRY FORM

name _____

address _____

city _____ st _____ zip _____

phone _____

email _____

Would you like to be added to our exhibition opportunities list? Y/N

Entry Checklist

Please be sure you have completed and included all of the following:

- Up to 30 images (jpegs recommended)
- \$35.00 check or money order (\$3.00 additional charge per 35mm slide entered) Make checks payable to TFAA.
- Resume and Bio
- Image List
- Artist Statement

Works included in the proposal need not be the final works in the exhibition, but they must accurately reflect the quality, subject matter, media, quantity, and general dimensions of the Target Gallery exhibition. Artists may submit up to 30 images for consideration.

I agree to all provisions of entry to this exhibition, including agreement that the artwork selected will be for sale and available for the duration of the exhibition.

signature _____ date _____

How did you hear about this opportunity?

- Torpedo Factory website other (please specify) national publication (please specify)

(please return this section only)