

## Exhibition Calendar

Monday, November 17, 2008

Deadline for entries

Wednesday, December 17

Artist Notifications

*Artists please note that the notifications are sent out exactly one month from the entry deadline. This is necessary for the processing involved and to give the juror time to review all of the submissions. Thank you for your patience.*

January 22 – February 22, 2009

Exhibition Dates

February 12, 2009 6-8pm

Artists' Reception

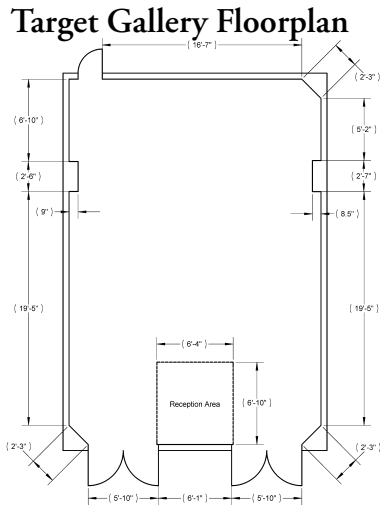

Please see "Limitations" for size requirements.

### Entry Checklist

Please be sure you have completed and included all of the following:

- completed entry form
- \$35.00 check or money order (\$3.00 additional charge per 35mm slide entered)  
Make checks payable to TFAA.
- CD or slides
- SASE (self-addressed stamped envelope)

## Guidelines

All work must be for sale. A commission of 40% will be taken on all works sold as a result of this exhibition. Payment will be mailed to the artist within 30 days of the exhibition closing. Works are insured while in Target Gallery. Artists are required to sign a Loan Agreement and a Terms & Condition Agreement if accepted. The Target Gallery will keep the slides and images of accepted works and reserves the right to reproduce the images for all media and publicity purposes.

## Delivery

Artists are responsible for shipping their work to the gallery in sturdy, reusable boxes. **Return shipping must be prepaid and enclosed with artwork.** Neither Target Gallery nor the Torpedo Factory Art Center will be responsible for any damage incurred in transit.

## Limitations

Work should be less than 15 feet overall (height + width + length), with no one dimension measuring more than 7 feet. Final measurements must be inclusive of frame, if applicable. Weight may not exceed 150 pounds. All entries must have been conceived and created by the artist submitting the work. All work selected must be ready for exhibit: 2D work must be framed with secure hanging devices; 3D work must be suitably prepared with instructions for installation. The gallery reserves the right to reject work that differs from submitted images.

## Application

The application materials must be received in the Target Gallery no later than 5 pm on Monday, November 17, 2008.



prospectus

# BookEnds

*the book as art*

January 22- February 22, 2009

### CALL FOR ENTRIES:

BookEnds an exhibition that focuses on the book as art and will be open to all artists nationally and internationally. The exhibition will be split between two venues, Torpedo Factory Art Center's Target Gallery and Pyramid Atlantic: A Center for Print, Paper and Book Arts. The juror for this exhibition is Helen Frederick, Founder and former director of Pyramid Atlantic. Frederick will choose the work that will be on display at both galleries.

**JUROR: Helen Frederick**

**DEADLINE:**  
**November 17, 2008**

[www.torpedofactory.org](http://www.torpedofactory.org)



105 N. Union St.  
Alexandria, VA 22314  
703 - 838 - 4565 x 4

[targetgallery@torpedofactory.org](mailto:targetgallery@torpedofactory.org)

## Juror: Helen Frederick

Helen C. Frederick is recognized as an artist using printmaking, artist books, electronic media and installation works as a basis for commentary. She is the founder of **Pyramid Atlantic**, a Center for Contemporary Collaborative Projects in Printmaking, Hand Paper Making, Digital Media and the Art of the Book. Frederick's work is included in the Whitney Museum of Art (NYC), National Gallery of Art, Library of Congress and Smithsonian American Art Museum (DC) and other collections around the world. Her activity as a lecturer, juror and curator nationally and internationally, have her currently engaged in the following exhibitions; *International Print Exhibition*, USA and Japan, 2008 featuring the Tamarind Institute, SOLO Impressions, Segura Publishing, Paulson Press and Pyramid Atlantic. She has been featured in many publications to include the *Complete Printmaker* (revised 1989), *The Best of Printmaking* (1997), Dieter Roth in America (2004) Germany, and *Papermaking for Printmakers* (2005) UK.

### Awards

Cash awards will be given to "Best in Show" and "Honorable Mention" award winners.

### About the Gallery

The Target Gallery, national exhibition space for the Torpedo Factory Art Center, is open to the public Wednesday through Sunday from noon to 6pm, and every Thursday until 9pm

For more info visit [www.torpedofactory.org](http://www.torpedofactory.org) and click on "Target".

## Directions For Entry

1. **We now accept online submission!** (visit our website & click on "Exhibition Opportunities" for more details).

Image entry will be PC compatible JPEG digital files and by 35mm slides only. Review will be by digital image only. We strongly suggest digital submission. We can only accept email submissions via the online submission form. Images of up to three works may be submitted. Only one detail image per each work may be included. CDs must contain the artist's name on both the actual CD and the case. JPEGs should be no larger than 300 dpi at approximately 4 by 6 inches. All digital files must be in JPEG format and must include the artist's name and title of the submission (smithpainting5.jpg). Please do not use quotations or spaces in file names. Slides must be labeled with the artist's name, title, media, and dimensions. Mark the lower left-hand corner of the front with a red dot.

2. Include a self-addressed stamped envelope (SASE) with sufficient postage for the return of slides or CDs.
3. A non-refundable fee of \$35.00 must accompany each entry form. **All 35mm slide submissions will require an additional charge of \$3.00 per slide.** Checks are to be made payable to the Torpedo Factory Artists' Association.
4. The entry form must be complete and include media, dimension information, and be sure to sign and date.
5. If you would like to submit more than three entries per application then each additional entry must include \$10 for each entry over the initial three. Only one detail per entry image allowed.

# BookEnds

*the book as art*

## ENTRY FORM

Entries must be received no later than:  
**Monday, November 17, 2008**

artist \_\_\_\_\_  
address \_\_\_\_\_  
city \_\_\_\_\_ st \_\_\_\_\_ zip \_\_\_\_\_  
phone \_\_\_\_\_ Would you like to be  
added to our exhibition  
email \_\_\_\_\_ opportunities list? y/n

### Entry 1

title \_\_\_\_\_  
media \_\_\_\_\_  
size (framed) \_\_\_\_\_ year executed \_\_\_\_\_  
detail image included? y/n

for gallery use only: ACCEPTED / DECLINED

### Entry 2

title \_\_\_\_\_  
media \_\_\_\_\_  
size (framed) \_\_\_\_\_ year executed \_\_\_\_\_  
detail image included? y/n

for gallery use only: ACCEPTED / DECLINED

### Entry 3

title \_\_\_\_\_  
media \_\_\_\_\_  
size (framed) \_\_\_\_\_ year executed \_\_\_\_\_  
detail image included? y/n

for gallery use only: ACCEPTED / DECLINED

I agree to all provisions of entry to this exhibition,  
including agreement that the artwork selected will be  
for sale and available for the duration of the exhibition.

signature \_\_\_\_\_ date \_\_\_\_\_

How did you hear about this opportunity?

- Torpedo Factory website  other (please specify)  national publication (please specify)

(please return this section only)